

***All the electrical products must be installed and maintained by the professional skilled person.**

Installation Manual

Suitable for the Model: Factory-840

Please read the specification carefully before the installation.

1. Please shut off the power supply before installation.
2. Install the fixing spring to the ceiling as ① of FIG.1
Connect the electrical wire as ② of FIG.1
Fix the pendant kit to the fixing spring by the screws as ③ of FIG.1
3. Assemble the module and driver into the housing as the ① of FIG.2.
Assemble the Lens as the ② of FIG2.
Assemble the PC shade as the ③ of FIG2.
Assemble the fixing ring of the shade as the ④ and fix it in tightly by the screws as the ⑤ of FIG2.
- 4.. Finished installation. FIG.3

● Lamp source model:

Luminus 30W, max. 4500Lm

Input voltage: 220V/50Hz ~

FIG. 1

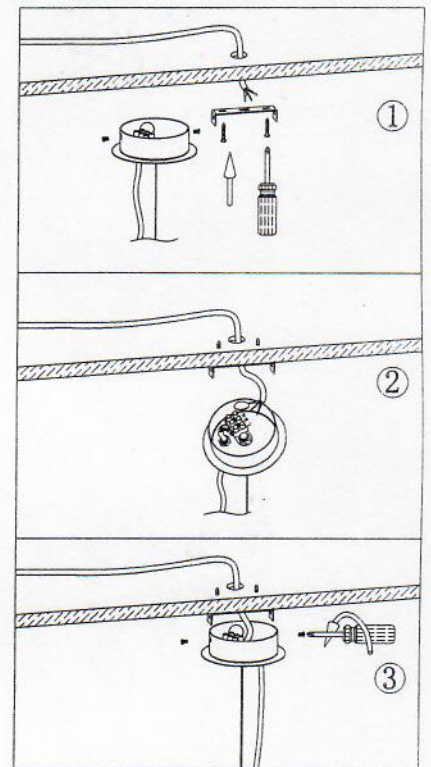

FIG. 2

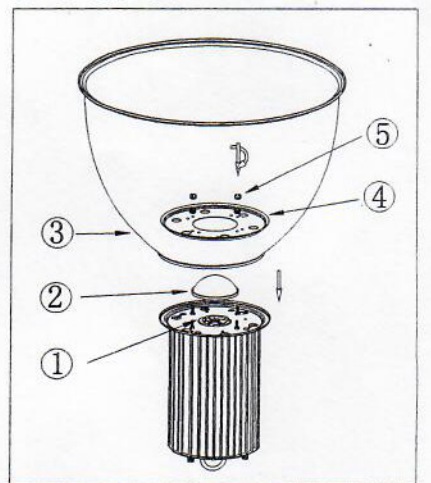

FIG. 3

